

KCD Series SMD Shielded Power Inductor Size 1204



FEATURES

Magnetically shielded version which results in a low leakage field;
Highest possible current loading for SMD Inductors;
Low self-losses;
Quantity: 500pcs;

APPLICATIONS

Perfectly suitable for switching regulators with high efficiency;
Integrated DC/DC-converter;
Switching regulators with low operating voltages;

Dimensions: [mm]

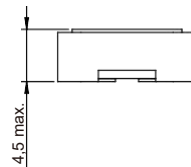
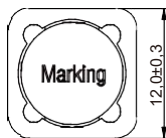
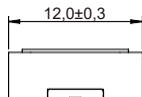
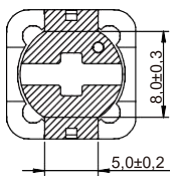

Land Patterns: [mm]

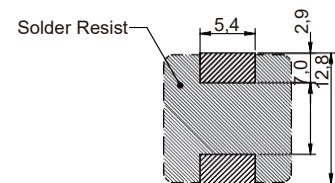

Electrical Properties:

Part No	Inductance (μH)	Tolerance	Temperature Rise Current (A)	Saturation Current (A)	DCR Typ (Ω)	DCR Max. (Ω)
KCD1204-0R6N	0.6	±30%	9.5	19.0	0.0045	0.0055
KCD1204-1R0N	1.0	±30%	8.5	13.9	0.0055	0.007
KCD1204-1R8N	1.8	±30%	7.6	10.2	0.0075	0.0095
KCD1204-2R5N	2.5	±30%	6.8	8.5	0.0085	0.011
KCD1204-3R3N	3.3	±30%	5.9	7.1	0.0115	0.013
KCD1204-4R7N	4.7	±30%	5.2	6.3	0.0135	0.016
KCD1204-6R8N	6.8	±30%	4.3	4.7	0.020	0.025
KCD1204-100M	10	±20%	3.8	4.2	0.025	0.030
KCD1204-120M	12	±20%	3.5	3.6	0.030	0.038
KCD1204-180M	18	±20%	3.2	3.2	0.037	0.043
KCD1204-220M	22	±20%	2.9	3.1	0.045	0.054
KCD1204-330M	33	±20%	2.3	2.5	0.075	0.085
KCD1204-470M	47	±20%	2.0	2.1	0.105	0.125
KCD1204-101M	100	±20%	1.3	1.4	0.25	0.27
KCD1204-221M	220	±20%	0.95	1.0	0.46	0.48
KCD1204-102M	1000	±20%	0.38	0.5	2.70	3.30

Operating Temperature : -40°C~+125°C

Saturation current will cause L to drop approximately 35% .

Temperature rise current: The actual value of DC current when the temperature rise is ΔT=40°C.