

Features

- Shielded construction
- Mn-Zn Ferrite core, High DC saturation Current
- Operating temperature: -40°C to +125°C



Application

- DC/DC Converter
- Power supply systems

Product Identification

KWD 1050 - 1R2 M

① ② ③ ④

- ① Series name: Wire Wound Power Inductor SMD
- ② Chip Size: 10.0x12.7x4.9mm
- ③ Inductance: 1.2uH
- ④ Tolerance: M: ±20% Y: ±15% S: ±10%

SHAPE AND DIMENSIONS

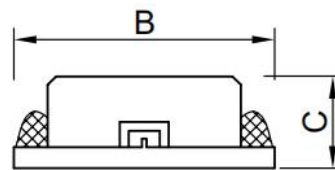
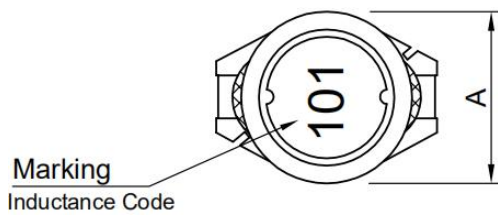

Recommended Layout:

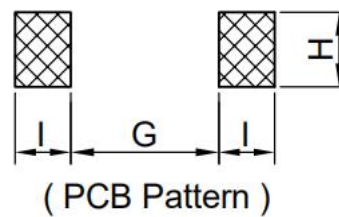
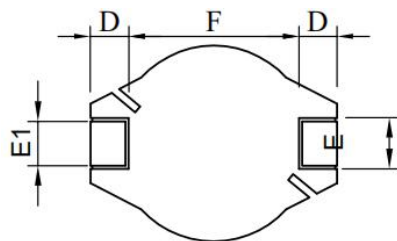

Unit:mm

A	B	C	D	E	E1	F	G	H
10.00 ±0.3	12.70 ±0.3	4.90 ±0.3	2.40±0.2	2.20 ±0.2	1.95 ±0.1	7.60±0.3	7.30 ref.	2.80 ref.

SPECIFICATIONS

KWD1050 Series

Part Number	Inductance (μH)	Fref (MHz)	RDC max (Ω)	Irms typ (A)	Isat typ (A)
KWD1050-1R0M	1.0 \pm 20%	120.0	0.017	5.80	11.0
KWD1050-1R5M	1.5 \pm 20%	100.0	0.020	5.30	9.00
KWD1050-2R2M	2.2 \pm 20%	90.0	0.027	4.70	7.70
KWD1050-3R0M	3.0 \pm 20%	80.0	0.030	4.20	6.80
KWD1050-4R7M	4.7 \pm 20%	50.0	0.040	3.40	5.40
KWD1050-7R0M	7.0 \pm 20%	32.0	0.055	2.80	4.40
KWD1050-100M	10.0 \pm 20%	30.0	0.065	2.70	3.70
KWD1050-120M	12.0 \pm 20%	25.0	0.080	2.60	3.30
KWD1050-150M	15.0 \pm 20%	20.0	0.085	2.30	3.00
KWD1050-180Y	18.0 \pm 15%	19.0	0.090	2.20	2.80
KWD1050-220Y	22.0 \pm 15%	18.0	0.100	2.00	2.60
KWD1050-270Y	27.0 \pm 15%	17.0	0.120	1.90	2.40
KWD1050-330Y	33.0 \pm 15%	15.0	0.160	1.60	2.10
KWD1050-390Y	39.0 \pm 15%	13.0	0.180	1.50	1.90
KWD1050-470Y	47.0 \pm 15%	12.0	0.190	1.43	1.80
KWD1050-560Y	56.0 \pm 15%	11.0	0.210	1.40	1.60
KWD1050-680Y	68.0 \pm 15%	9.0	0.340	1.10	1.40
KWD1050-820Y	82.0 \pm 15%	8.0	0.380	1.00	1.30
KWD1050-101S	100.0 \pm 10%	7.5	0.420	0.90	1.20
KWD1050-121S	120.0 \pm 10%	7.2	0.460	0.85	1.10
KWD1050-151S	150.0 \pm 10%	6.2	0.520	0.78	1.00
KWD1050-181S	180.0 \pm 10%	5.8	0.700	0.70	0.90
KWD1050-221S	220.0 \pm 10%	5.2	0.800	0.65	0.80
KWD1050-271S	270.0 \pm 10%	4.8	1.100	0.54	0.70
KWD1050-331S	330.0 \pm 10%	4.5	1.200	0.50	0.65
KWD1050-391S	390.0 \pm 10%	4.2	1.400	0.48	0.60
KWD1050-471S	470.0 \pm 10%	3.0	1.600	0.44	0.55
KWD1050-561S	560.0 \pm 10%	2.7	1.800	0.42	0.50
KWD1050-681S	680.0 \pm 10%	2.6	2.300	0.36	0.47
KWD1050-821S	820.0 \pm 10%	2.5	2.600	0.34	0.42
KWD1050-102S	1000.0 \pm 10%	2.0	3.200	0.30	0.38
KWD1050-122S	1200.0 \pm 10%	2.0	3.600	0.28	0.35

- Electrical specifications at 25°C
- Irms base on Temp. rise 40°C max
- Isat base on $\Delta L/L0A=10\%$ max